



# WHAT'S NEW

EXTENSION PRODUCTION PLANNING / 2025 H2

Copyright © 2026, AXtension B.V.

No part of this publication may be reproduced in any form, by photocopy, microfilm or any other means, except with explicit written permission of:

AXtension B.V.  
Noorderpoort 9D  
5916 PJ Venlo  
The Netherlands

Tel.	: +31 (0)77 3232622
Fax	: +31 (0)77 3232627
E-mail	: <a href="mailto:info@axtension.com">info@axtension.com</a>
Internet	: <a href="http://www.axtension.com">www.axtension.com</a>
Trade register number	: 12037027, Noord- en Midden Limburg Chamber of Commerce
Bank	: Rabobank Gelderse Vallei
Bank account number (IBAN)	: NL43RABO0102787077
VAT number	: NL806.969.349.B01

Please note: Axtension® is a registered trademark owned by More Dynamics Licensing

# Table of Contents

Axtension® Production Planning ..... 4

Reschedule planned order with Schedule mode referenced ..... 4

Relocated cluster select ..... 4

Visualize intercompany production orders ..... 4

## Axtension® Production Planning

### Reschedule planned order with Schedule mode referenced

The **Schedule mode referenced** will not only reschedule referenced production orders, but also referenced planned production orders shown in the resource planning of Axtension® Production Planning

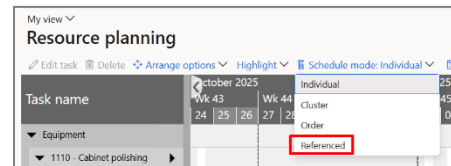

### Relocated cluster select

The **Cluster Select** action is now moved and placed as Schedule mode **Cluster**.

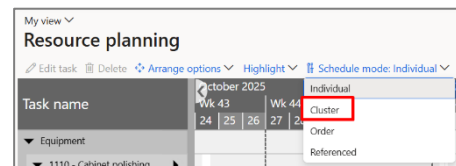

### Visualize intercompany production orders

This release of Axtension® Production Planning introduces the ability to visualize intercompany production orders exploded out of a project related production order.

The visualization is added to the task planning of Axtension® Project Management.

To visualize an intercompany production order, open the task planning of Axtension® Project Management and enable the **Production order** toggle and the **Show intercompany production order** toggle.

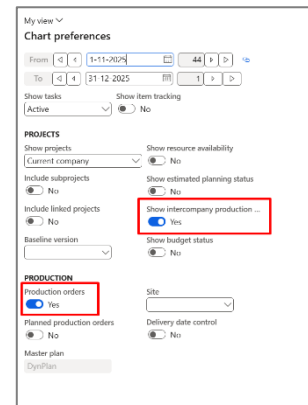

Enabling the **Show intercompany production orders** toggle will show intercompany production orders in the project task plan with the total duration of the production order and with the legal entity code as a prefix.

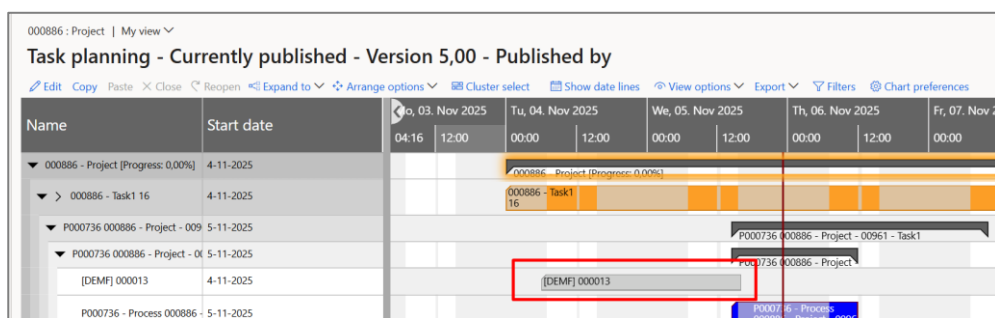

**Note:** Intercompany production orders are visualized from the start date until the end date of the production order. Individual operations of production orders are not visualized.